

arts & architecture

EDITOR: JOHN ENTENZA

EDITORIAL ASSOCIATES

Flora M. Brown
Herbert Matter
James Fitzsimmons
Jules Langsner
Peter Yates
Bernard Rosenthal

LAYOUT

Frederick A. Usher, Jr.
John Follis

STAFF PHOTOGRAPHERS

Harry Baskerville
Julius Shulman

EDITORIAL ADVISORY BOARD

Dr. Grace L. McCann Morley
William Wilson Wurster, A.I.A.
Walter Gropius, A.I.A.
Ernest Born, A.I.A.
Richard J. Neutra, A.I.A.
Welton Becket, A.I.A.
Victor Gruen, A.I.A.
Marcel Breuer, A.I.A.
Gardner A. Dailey, A.I.A.
H. Roy Kelley, F.A.I.A.
Whitney R. Smith, A.I.A.
John Rex, A.I.A.
Mario Corbett, A.I.A.
A. Quincy Jones, A.I.A.
Fred Langhorst, A.I.A.
Raphael Soriano, A.I.A.
George Vernon Russell, A.I.A.
John Funk, A.I.A.
Gregory Ain, A.I.A.
Henry Hill, A.I.A.
Ira J. Bach, A.I.P.
Konrad Wachsmann
Hollis S. Baker
Eduardo F. Catalano
Alvin Lustig
Paul Rudolph
Craig Ellwood
Isamu Noguchi
Finn Juhl
George Nelson
Gyorgy Kepes
Harriet Janis
Garrett Eckbo
Edgar Kaufmann, Jr.
Dorothy Liebes
Esther McCoy
Edward Frank
Claire Falkenstein
Harold W. Grieve, A.I.D.

ADVERTISING REPRESENTATIVES:

Ray C. Watson Co.
1709 West Eighth Street
Los Angeles 17, California
Ray C. Watson, Loren Hays, Daryl James

CONTENTS FOR JULY 1955

ARCHITECTURE

| | |
|--|----|
| Hillside Houses by Greta Grossman | 16 |
| Beach House by Robert Bruce Tague, architect | 18 |
| University Building by Cato, Austin, Evans, architects, in association with Edmund Furley | 20 |
| House by James Durden | 22 |
| Summer House by Carter H. Manny, architect | 23 |
| Commercial Building by A. Quincy Jones and Frederick E. Emmons, architects | 24 |

SPECIAL FEATURES

| | |
|--|----|
| Books | 6 |
| Music | 7 |
| Art | 10 |
| Notes in Passing | 11 |
| Psychology and the Architect by Kreg Martin | 12 |
| William Brice by Frederick Wight | 14 |
| "California Designed," an exhibition | 26 |
| J.O.B. | 35 |
| Currently Available Product Literature and Information | 37 |

Ray C. Watson Co.
402 Times Building
Portland 4, Oregon
Fred Goetz

3077 Turk Street
San Francisco 18, California
William J. Barron

ARTS & ARCHITECTURE is published monthly by John D. Entenza, 3305 Wilshire Boulevard, Los Angeles 5, California. Established 1911. Entered as second class matter January 29, 1935, at the Post Office, Los Angeles, California, under the Act of March 3, 1879. Price mailed to any address in the United States, \$5.00 a year; to foreign countries, \$6.50 a year; single copies 50 cents. Editorial material and subscriptions should be addressed to the Los Angeles office. Return postage should accompany unsolicited manuscripts. One month's notice is required for a change of address or for a new subscription.

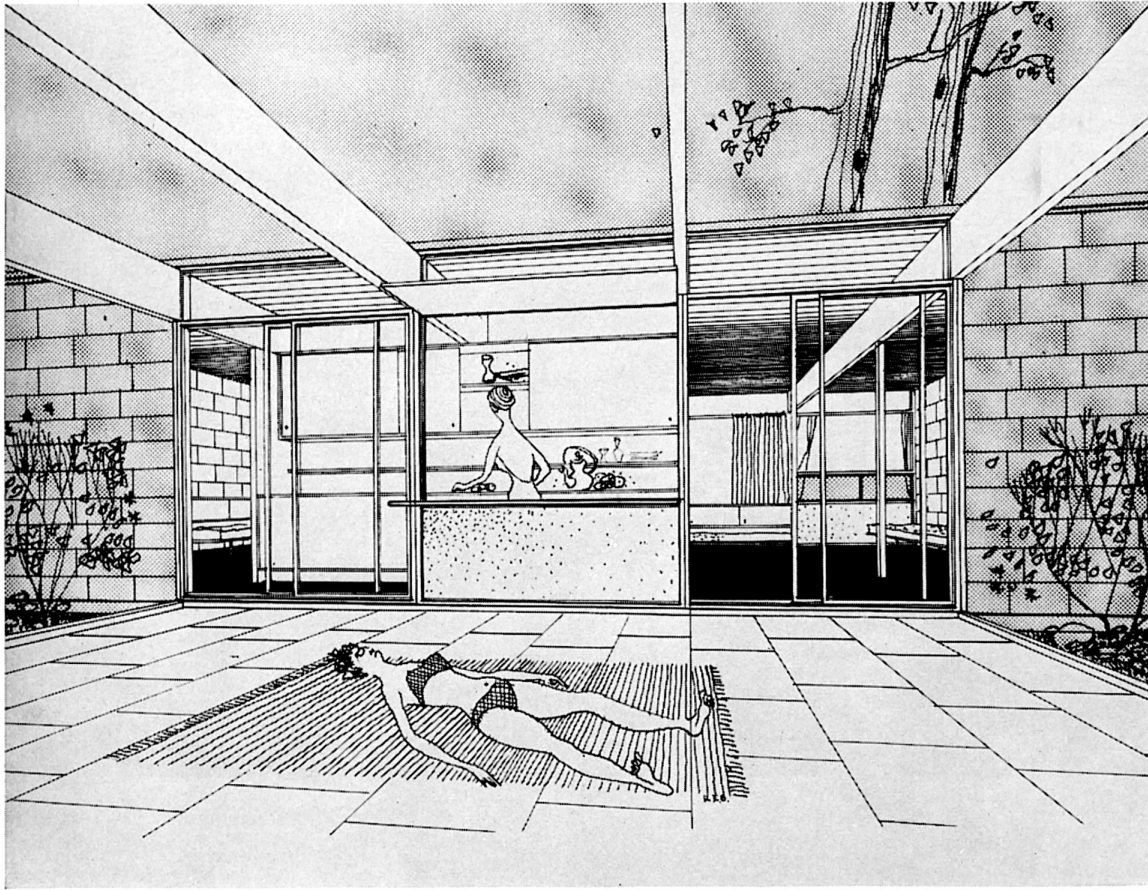

This construction is the first unit of an eventual living-entertaining-design workshop. Upon completion, the owners will make this a year around home. There is a view of the lake and the trees directly north with dunes landscape in all directions. The site is fairly heavily wooded, with good ground cover and wild flowers, and will be allowed to remain in its natural state. This initial unit is to be for the present an all purpose space for informal living, entertaining, and sleeping, in summer and on weekends.

Construction is concrete block, plank and beam, concrete floor, perimeter warm air heat, sliding Novoply doors, Arcadia sliding glass doors to the terrace, fixed glass, Cemesto and Alwintite sliding windows to the northeast. The terrace is screened on two sides and on top. The color of the structural materials, furnishings and fabrics will be largely black, white, gray, with strong colors occurring primarily in paintings.

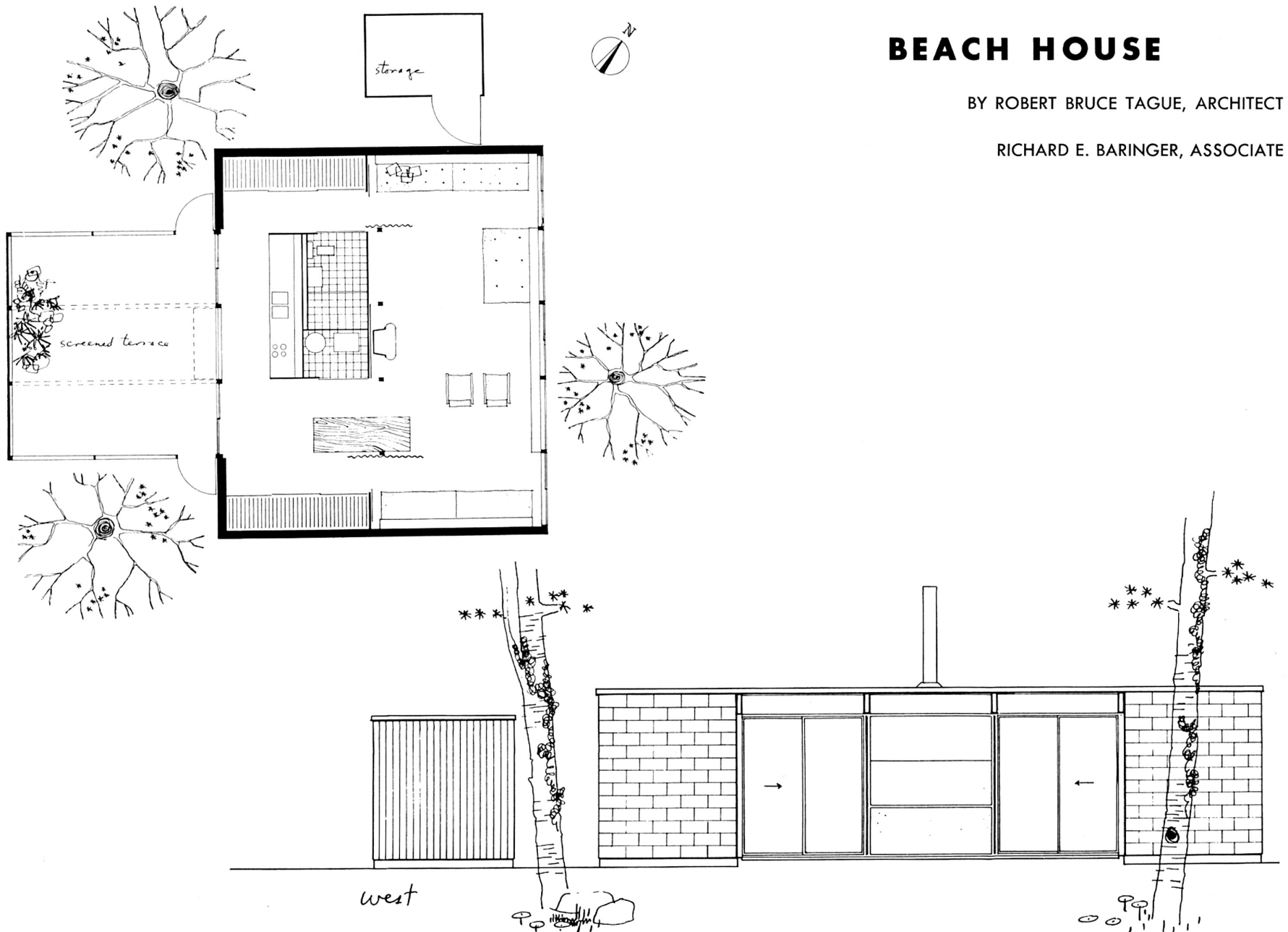

BEACH HOUSE

BY ROBERT BRUCE TAGUE, ARCHITECT

RICHARD E. BARINGER, ASSOCIATE

